



ISEO Zero1
ELECTRONIC
SOLUTIONS



ISEO Zero1

ELECTRONIC SOLUTIONS

1 ACCESS CONTROL

2 ELECTRONIC LOCKS

3 EMERGENCY EXIT CONTROLS

4 FIRE DOOR CONTROLS AND FIRE PREVENTION

5 ELECTRIC LOCKS





**Electronic
locks**

Electronic locks

Iseo electronic locks combine the features functionalities of high security mechanical locks with the electronic management in order to increase door security and comfort for end users.

Thanks to motors or electromagnets, the electronic control allows automate locks' opening and/or closing movements. Thus the security of the door is guaranteed in any situation.

The sensors within the locks allow to integrate them in monitoring and building management systems.

Our range of electronic locks includes different models, meets any installation and functionality needs and suits to any types of doors.

Iseo electronic locks have been conceived and manufactured according to European standards and have obtained different product certifications in order to meet specific national and international legal requirements.

The electronic locks are supplied with Lockbus interface, can be integrated in any Iseo access control system and don't require any further interface modules. Therefore the installation and the communication security have been optimized.

THESIS 2.0

Top Exit DGT

Multiblindo  Motion

x1R

Top Exit DGT



Top Exit DGT is a smart closing device conceived and manufactured specifically for applications on metal frames in steel and aluminum.

Key points

The motorized movement of the deadbolts (and latchbolt) during both opening and closing operations is controlled by specific sensors and a powerful microprocessor, which guarantee constant security.

The lock software allows to manage the “hold open” function: the deadbolts are constantly unlocked allowing free entrance to anybody.

Top Exit DGT is available in three different versions that suit any application exigency:

- TYPE A with motorized deadbolts and adjustable roller latchbolt
- TYPE B with motorized deadbolts and mechanical latchbolt (manual operation)
- TYPE C with motorized deadbolts and latchbolt

All the versions can operate mechanically too, because the european cylinder and/or panic exit device operations don't depend on power supply and impediments deriving from the contemporary operation of the motor.

The control unit allows the opening from exterior through accessories such as proximity readers, radio remote controls and electronic keys and through the connection to centralized access control systems.



It is certified

Top Exit DGT has been conceived and manufactured in compliance with European standards UNI EN 1125, EN 12209, 15685 and 14846.

Classification example:



Main features

- Central or three locking points lock with rotating deadbolts.
- European profile cylinder hole.
- Handle follower 8 mm.
- Backset 35 mm.
- Centre distance 85 mm.
- Deadbolts status sensors, in line frame and failed locking through deadbolt signals, motorized latchbolt, handle status according to versions.
- “Hold open” function.
- 5 or 15 sec. courtesy time (door opening time) according to versions.
- Lockbus interface (optional).

Top Exit DGT Installation scheme

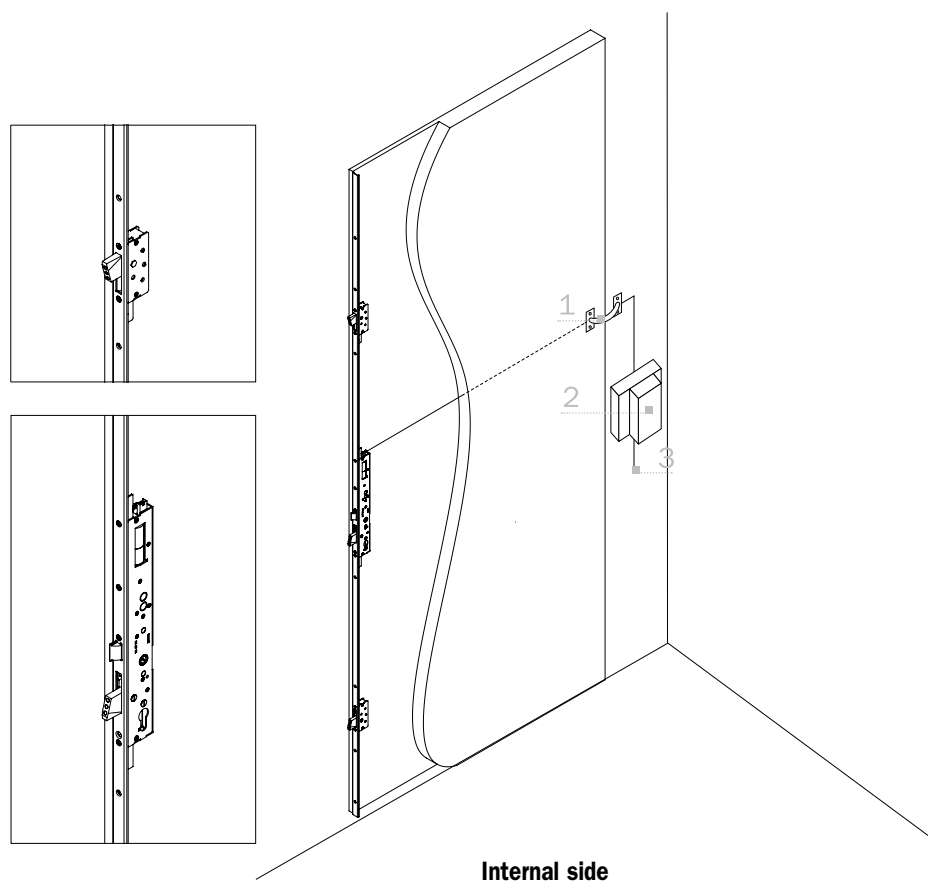

1. Control unit
2. Concealed lead covers
3. 220 Vac electric power



Top Exit DGT type A

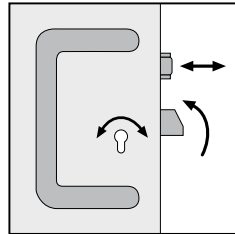
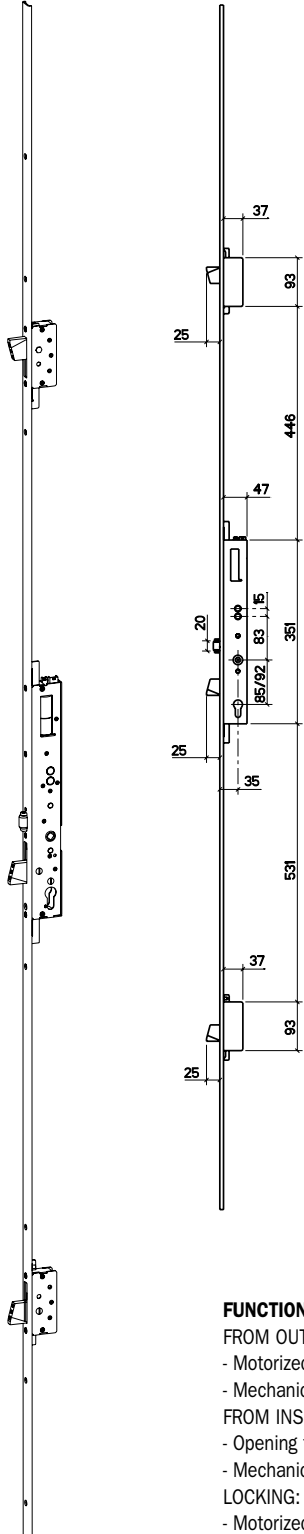

FROM INSIDE

Key to open and close.
Electronic remote control.

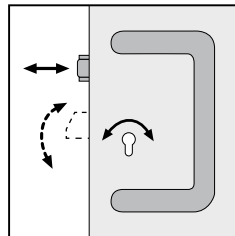

FROM OUTSIDE

The key operates the latchbolt and
deadbolts both when opening and closing.
Electronic remote control.

LOCK STATUS MICROSWITCH

CODE	DESCRIPTION	
-	Deadbolt	●
-	In frame door signal	●
-	Failed locking through deadbolts alarm	●

● = standard

FUNCTIONS

FROM OUTSIDE:

- Motorized opening through deadbolts;
- Mechanical opening through European profile cylinder.

FROM INSIDE:

- Opening through handle;
- Mechanical opening through European profile cylinder.

LOCKING:

- Motorized locking when the door is closed or 15 seconds delayed locking time;
- Through European profile cylinder.

An automatic system allows to separate MECHANICAL and MOTORIZED operations in order to guarantee opening even in case of emergency and to safeguard the electromechanical parts.

Package

Code

Top Exit DGT type A

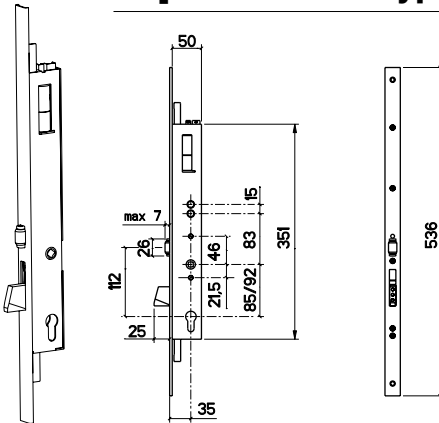

SINGLE POINT LOCK. In compliance with UNI EN 14846 standard.
Flat STAINLESS steel front plate section mm 25x3, length mm 536.
Supplied with: Control unit. Connecting cables. Fixing screws.
Handle follower.

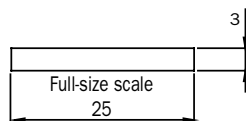

Backset 35 mm. Centre distance 85 mm.

1 **000007222885**

Top Exit DGT type A

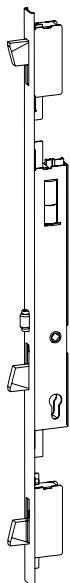

MULTIPOINT LOCK. In compliance with UNI EN 14846 and prEN 15685 standards.
U-shaped STAINLESS steel front plate section mm 24x5, length mm 2300.
Supplied with: Control unit. Connecting cables. Fixing screws.
Handle follower.

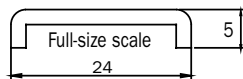

Backset 35 mm. Centre distance 85 mm.

1 **0000017422885**

TECHNICAL FEATURES

TOP LINE

Power supply	230Vac 20W
Dimensions	210x120x65 mm
Operating functions:	-10+60°C
Courtesy time	5/15 sec.
Deleyed locking time	2 sec.
Status relay	3



Top Exit DGT type B

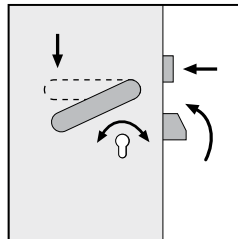
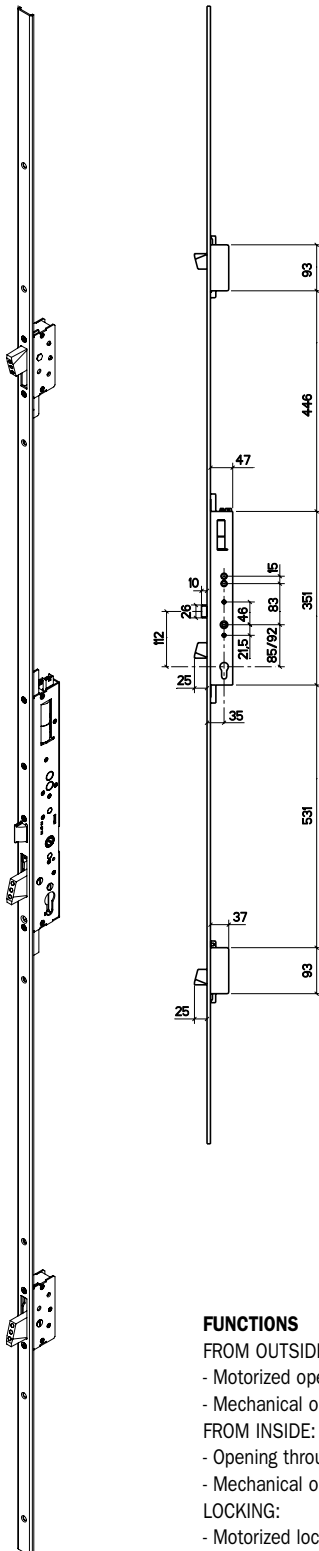

FROM INSIDE

- Key to open and close.
- Handle to open bolts and deadbolts.
- Electronic remote control.

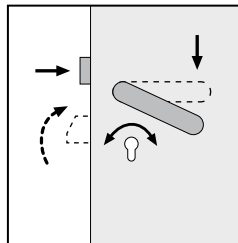

FROM OUTSIDE

- The key operates the latchbolt and deadbolts both when opening and closing.
- When the deadbolts are unlocked, the handle operates the latchbolt.
- Electronic remote control.

CONTROL MICROSWITCH

CODE	DESCRIPTION	
-	Deadbolt	●
-	In frame door signal	●
-	Failed locking through deadbolts alarm	●
X	Handle control	○

- = Standard
- = On request

If you wish to order the lock with status microswitch, please add the reference codes above to the lock code. Example: 1741688501X Top Exit DGT E 35 I 85 with handle microswitch.

Doors opening direction.

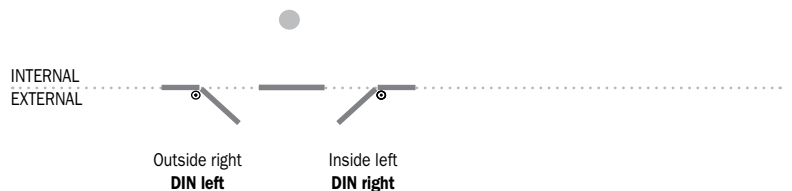

FUNCTIONS

FROM OUTSIDE:

- Motorized opening through deadbolts and latchbolt operation through handle;
- Mechanical opening through European profile cylinder.

FROM INSIDE:

- Opening through handle;
- Mechanical opening through European profile cylinder.

LOCKING:

- Motorized locking when the door is closed or 15 seconds delayed locking time;
- Through European profile cylinder.

An automatic system allows to separate mechanical and motorized operations in order to guarantee opening even in case of emergency and to safeguard the electromechanical parts.

Package

Code

Top Exit DGT type B

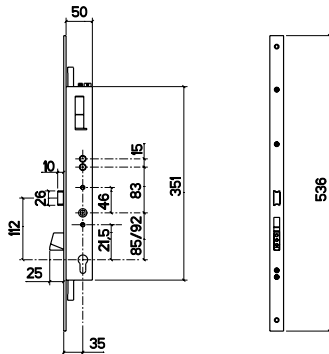
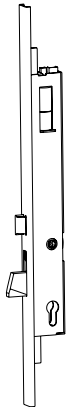

SINGLE POINT LOCK. In compliance with UNI EN 14846 standard.
Flat STAINLESS steel front plate section mm 25x3, length mm 536.

Supplied with: Control unit. Connecting cables. Fixing screws.
Splitted handle follower.

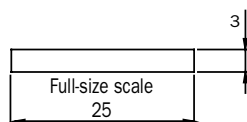

Backset 35 mm. Centre distance 85 mm. RIGHT HAND.

1 **00000721688501**

Backset 35 mm. Centre distance 85 mm. LEFT HAND.

1 **00000721688502**

Top Exit DGT type B



MULTIPOINT LOCK. In compliance with UNI EN 14846 and prEN 15685 standards.

U-shaped STAINLESS steel front plate section mm 24x5, length mm 2300.

Supplied with: Control unit cables. Fixing screws.
Splitted handle follower.

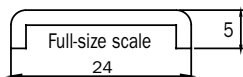

Backset 35 mm. Centre distance 85 mm. RIGHT HAND.

1 **00001741688501**

Backset 35 mm. Centre distance 85 mm. LEFT HAND.

1 **00001741688502**

TECHNICAL FEATURES

TOP LINE

Power supply	230Vac 20W
Dimensions	210x120x65 mm
Operating functions:	-10+60°C
Courtesy time	5/15 sec.
Deleyed locking time	2 sec.
Status relay	3



Top Exit DGT type C

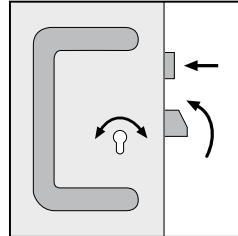
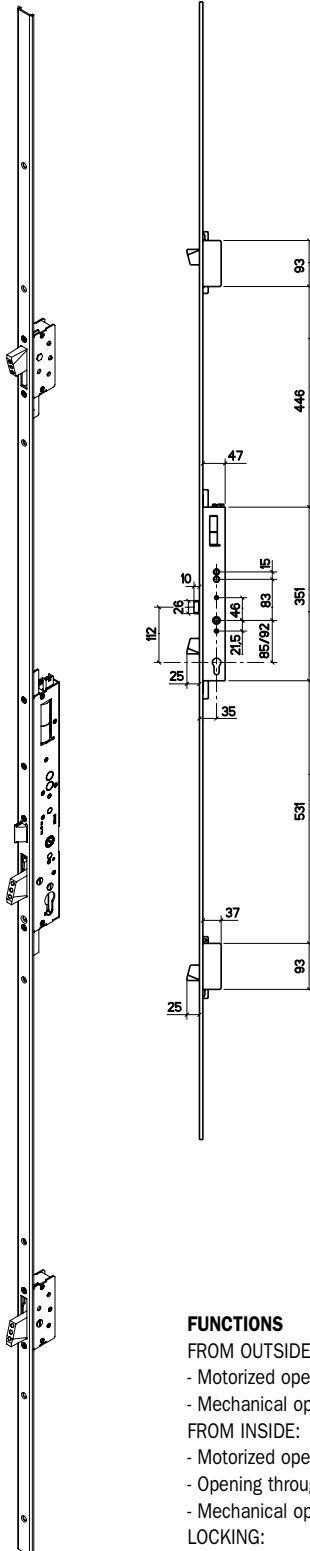

FROM INSIDE

- Key to open and close.
- Handle to open bolts and deadbolts.
- Electronic remote control.

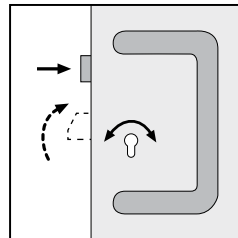

FROM OUTSIDE

- The key operates the latchbolt and deadbolts both when opening and closing.
- When the deadbolts are unlocked, the handle operates the latchbolt.
- Electronic remote control.

CONTROL MICROSWITCH

CODE	DESCRIPTION	
-	Deadbolt	●
-	In frame door signal	●
-	Failed locking through deadbolts alarm	●
X	Handle control	○

- = Standard
- = On request

If you wish to order the lock with status microswitch, please add the reference codes above to the lock code. Example: 1741688501X Top Exit DGT E 35 I 85 with handle microswitch.

Doors opening direction.

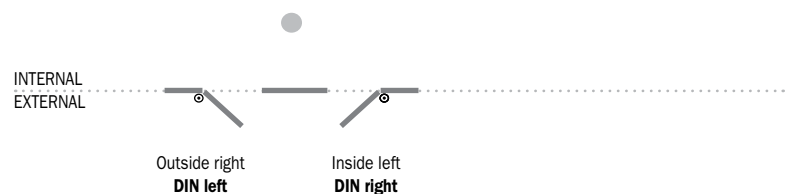

FUNCTIONS

FROM OUTSIDE:

- Motorized opening through deadbolts and latchbolt;
- Mechanical opening through European profile cylinder.

FROM INSIDE:

- Motorized opening through deadbolts and latchbolt;
- Opening through handle follower operation;
- Mechanical opening through European profile cylinder.

LOCKING:

- Motorized locking when the door is closed or 15 seconds delayed locking time;
- Through European profile cylinder.

An automatic system allows to separate mechanical and motorized operations in order to guarantee opening even in case of emergency and to safeguard the electromechanical parts.

Package

Code

Top Exit DGT type C

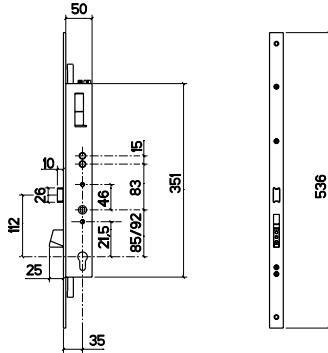
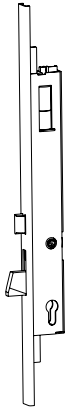

SINGLE POINT LOCK. In compliance with UNI EN 14846 standard.
Flat STAINLESS steel front plate section mm 25x3, length mm 536
Supplied with: Control unit. Connecting cables. Fixing screws.
Splitted handle follower.

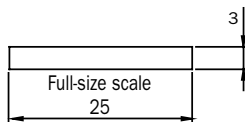

Top Line. Backset 35 mm. Centre distance 85 mm. RIGHT HAND.	1	00000721788501
Top Line. Backset 35 mm. Centre distance 85 mm. LEFT HAND.	1	00000721788502
Compact Line. Lockbus Interface. Backset 35 mm. Centre distance 85 mm. RIGHT HAND.	1	00000721888501
Compact Line. Lockbus Interface. Backset 35 mm. Centre distance 85 mm. LEFT HAND.	1	00000721888502

Top Exit DGT type C

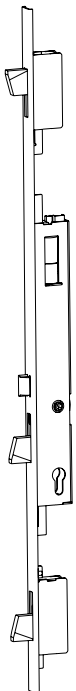

MULTIPOINT LOCK. In compliance with UNI EN 14846 and 15685 standards.
U-shaped STAINLESS steel front plate section mm 24x5, length mm 2300.
Supplied with: Control unit. Connecting cables. Fixing screws.
Splitted handle follower.

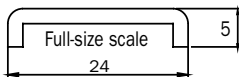

Top Line. Backset 35 mm. Centre distance 85 mm. RIGHT HAND.	1	000001741788501
Top Line. Backset 35 mm. Centre distance 85 mm. LEFT HAND.	1	000001741788502
Compact Line. Lockbus Interface. Backset 35 mm. Centre distance 85 mm. RIGHT HAND.	1	000001741888501
Compact Line. Lockbus Interface. Backset 35 mm. Centre distance 85 mm. LEFT HAND.	1	000001741888502

TECHNICAL FEATURES

	TOP LINE	COMPACT LINE
Power supply	230Vac 20W	8/24Vdc 25W
Dimensions	210x120x65 mm	36x90x58 mm
Operating functions:	-10+60°C	-10+60°C
Courtesy time	5/15 sec.	5 sec.
Deleyed locking time	2 sec.	2 sec.
Status relay	3	1

Package

Code

Accessories



STRIKING PLATE SET IN STAINLESS STEEL,
adjustable and reversible.

For multipoint lock type A

1 **000098174201**

For multipoint lock type B and C

1 **000098174150**



STRIKING PLATE IN STAINLESS STEEL,
adjustable and reversible.

For single point lock type A

1 **2001117420000**

For single point lock type B and C

1 **2000017415000**

1 - Field of application

These general terms of sale are intended to regulate the present and future sale contracts between the parties with the exception of any different conditions agreed in writing. Any general term established by the Buyer shall not be applied to the parties' future relationships unless agreed in writing. The Buyer's acceptance of FIAM's offer or order confirmation, however made, shall imply the application of these general terms of sale to the sale contract.

2 - Information data

The product features, prices and other data shown in FIAM's catalogues, price lists or any other documents as well as the features of samples and prototypes sent to the Buyer shall not be binding unless expressly mentioned in FIAM's offer or order confirmation.

FIAM reserves the right to make any necessary changes to their products in any moment. Any technical drawing or document given to the Buyer, which allows the manufacturing or assembly of the products or their parts, is property of FIAM. It cannot be used, copied, transmitted or communicated by the Buyer to a third party unless previously agreed with FIAM.

3 - Orders

Only written orders shall be accepted through an order confirmation.

Any offer made by FIAM's agents or representatives shall not be binding for FIAM until written confirmation of the latter.

For single orders with an amount lower than:

Italy	550,00 euro
EU	1.550,00 euro
Non-EU countries	3.000,00 euro

the following fixed operating expenses shall be invoiced:

Italy	25,00 euro
EU	78,00 euro

4 - Delivery

The delivery terms are:

Italy	Carriage Paid
EU countries	Carriage Paid
Non-EU countries	F.O.B. (Incoterms 2000)

The delivery terms are approximate in favour of FIAM with a fair tolerance margin. FIAM shall not be liable for any damage deriving from an anticipated, delayed or missing delivery, either full or partial. The risks connected to the supply shall pass on to the Buyer at the latest when the products leave FIAM's factory, unless the sale term or the applicable regulations provide for an earlier time.

5 - Prices – Payments

Prices, which include costs for packaging (packaging units are to be respected), shall be those in force at receipt of purchase order.

Payments, as well as any other amount payable to FIAM, shall be net at their premises. The Buyer shall not be entitled to suspend payments, even in case of disputes arising from supplied products.

Any payment dispute will entitle FIAM to suspend the manufacturing of the orders under execution and to ask the Buyer for suitable guarantees of payment and therefore to change the payment terms in force for future orders. No compensation with any credits towards FIAM shall be accepted.

For each invoice which will not have been paid by the due date, we will calculate accrued interest on arrears, by applying the official interest rate in force, according to D.LGS N. 192/2012 - implementation of Directives 2000/35/CE and 2011/7/UE. The supplied products shall remain FIAM's property until the full payment. To this end the Buyer shall undertake to do everything possible to grant in the Country where products are stocked a valid reservation of proprietary rights, or to put into force a warranty in favour of FIAM.

6 - Warranty

No returned product shall be accepted unless previously agreed with FIAM by filling in the return authorization request form. FIAM guarantees the conformity of the products with the legislation and technical standards in force in Italy.

Therefore, the buyer shall take the risk of eventual differences between Italian standards and the standards of the Country of destination of the products. FIAM guarantees the performance of their products only in relation to their stated use and application.

Any other use is considered as improper.

Should the Buyer resell these products, he shall be fully responsible to give his customers, at his own expenses, all the relevant information. The warranty is not valid in the following cases: products installation and/or use and/or maintenance not complying with FIAM instructions, modifications and/or repair without written authorization by FIAM, normal wear and tear.

FIAM's mechanical products are guaranteed for **10 years** against any engineering, material or manufacturing failures attributable to FIAM, provided they are properly used and installed. The electronic products and door closers are guaranteed for **3 years** from the date on the product label. In the absence of the label, the warranty declines unconditionally. Any replacement of components do not give rise to an extension of the warranty period for the whole product.

Claims shall be made in writing, on pain of forfeiture, within 8 days from the receipt of the goods for failures relating to quantity or for failures which could be

detected by the Buyer when receiving the goods; within 8 days from the discovery of hidden failures or non-conformities. Failures shall be exclusively assessed by FIAM's experts.

No claim against FIAM shall be accepted after the expiry of the warranty period. The Buyer shall lose the warranty right if payments are not regular. This warranty is limited to the replacement of the faulty part EXW FIAM.

No other reimbursement shall be made such as disassembly and assembly charges.

This warranty includes and replaces any other legal warranty for failures and conformity and excludes any other liability of FIAM connected to the supplied goods. Unless in case of fraud or gross negligence grave offence on the part of FIAM, the latter shall not be liable for direct, indirect or consequential damages to the buyer of the supplied products. In particular, the Buyer shall not be entitled to claim a damage refund, a price reduction or contract termination.

7 - User Licence agreement

Important

Please read carefully this end user License agreement. The installation or use of any software shown in this catalogue means that you accept the terms and conditions of the following agreement.

Ownership

ISEO SERRATURE S.P.A. (hereinafter ISEO), headquartered in Pisogne (BS), Via San Girolamo 13, and the productive or distribution companies of ISEO Group (hereinafter ISEO), as the only and exclusive owners, bestow the non-exclusive user license of any software contained in ISEO Zero1 product range, under the conditions described in the following paragraphs. The license is not a sale of the software and no expression contained in the license shall be construed to transfer any right or ownership.

License concession

ISEO grants the right to use one copy of the software on the type of computer and operating system for which the software was designed to work. ISEO recognizes the rights to make backup copies only for security and archiving.

Limitations on the right of use

The licensee is not authorized to rent, lease, share or to lend the software. The licensee is also not authorized to examine, modify, incorporate into another program, convert back to the original source code, decompile, disassemble or reverse engineer of the software.

The licensee is not authorized to remove, change or obscure the brand Iseo or indications relating to the entitlement. ISEO shall be informed and agree on any variation of the above mentioned limitations.

Warranty

ISEO does not warrant that the operation of the software will be free from failures or that defects in the software will be corrected. ISEO ensures that the software is compliant with the technical and functional characteristics described in the supporting documentation. ISEO will use reasonable efforts to intervene in case of any malfunction up to 12 months after the invoice.

Confidentiality

With the acceptance of this license, the licensee agrees to use the software only within his organization and not to assign or otherwise make the software, the technical knowledge of the program and supporting documentation available to third parties. The use of the software is closely related and limited Iseo in projects and products or correlated projects if previously agreed and authorized in writing by ISEO.

Copyright

The software is the exclusive property of ISEO and is protected by Italian law on copyright, by the rules contained in international treaties and by the laws in force in the country in which it is used. Third party's software, software tools, compilers, assemblers, debuggers, operating systems and any other software are included or used in conjunction with ISEO software. Copyright and any correlated licenses are indicated in technical manuals.

Limitation of liability and exclusion of damages

In no event will ISEO be responsible for any consequence, indirect, incidental or of any kind, including lost profits, business interruption, lost information, or other losses, arising out of the use or inability to use the software, even if ISEO has been advised on the eventuality of such damages.

Iseo responsibility for any direct damages to you or any third party will be in any event limited to gross negligence or willful misconduct.

8 - Competent Court – Applicable law

Any dispute arising from or connected with the contracts to which these general terms apply will be exclusively dealt with by the Court of Como; FIAM shall however be entitled to take legal action also before the Buyer's Court.

These general terms of sale are regulated by the Italian Law.

ISEO Zero1

ITALY

c/o: **Fiam** srl - Via Don Fasola 4
I-22069 Rovellasca (CO)
zero1-it@iseo.com
iseozero1@iseo.com



GERMANY

ISEO Deutschland GmbH
zero1-de@iseo.com



FRANCE

ISEO France s.a.s.
zero1-fr@iseo.com
+33 1 64835858

SPAIN

Cerraduras ISEO Ibérica S.L.
zero1-es@iseo.com



ASIA

ISEO Asia Pacific SDN. BHD.
zero1-asia@iseo.com
+603 80753331

ISEO Beijing

zero1-cn@iseo.com
+8610 58698079

UNITED ARAB EMIRATES

ISEO Middle East F.Z.E.
zero1-me@iseo.com
+971 4 2957220

SOUTH AFRICA

ISEO South Africa (Pty) LTD
zero1-za@iseo.com

ISEO[®]
www.iseo.com

ISEO Serrature s.p.a.
Via San Girolamo 13
I-22055 Pisogne (BS)
iseo@iseo.com

ISEO zero1
ELECTRONIC
SOLUTIONS

iseozero1.com