



**ISEO Zero1**  
ELECTRONIC  
SOLUTIONS



**Access  
control**



## Access control

**Aries**  
**Libra**  
**Stylos** Line  
**F9000**  
**Simply**  
**Sirio**

ISEO Zero1 is a wide range of electronic access control devices which meets every application and installation exigencies. You can choose different solutions according to door typology and security level you need:

- wired devices such as Stylos credential readers, control systems and smart solenoid locks;

- off-line battery operated devices which don't require any wiring, such as Aries electronic trim set and Libra electronic cylinder;

- mechatronic cylinders with power source on the key only, such as CSF F9000.

All the present devices, together with the ones which will be conceived in the future, can be combined to create integrated access control systems sharing identification systems (credential) and operating logic.

The Iseo Zero1 systems' functions change according to the different features and dimensions of the access control systems needed by the customers.

### SIMPLY

Control system for small and medium installations with relative low variations. It is based on the use of precoded card and without any software on PC. It is the electronic version of the mechanical MK systems.

### SIRIO

It is an advanced access control software allowing to manage both on-line and off-line accesses in an almost transparent way for the user. The web technology on which it is based, the various autonomous device levels and the modern functions make it one of the most advanced system available on the market, able to manage almost infinite users and gates. The system is totally scalable and can manage both small installations and installations with thousands of gates in different countries or continents. SIRIO's versatility and modularity allow to integrate not only access control systems, but also video surveillance, alarm, time attendance systems, etc.



THIS PRODUCT WAS NOMINATED FOR THE AWARD COMPASSO D'ORO ADI BY ADI DESIGN INDEX 2013



## Libra



Thanks to the quick and easy installation, the electronic cylinder LIBRA is the ideal and universal solution both for the replacement of mechanical European profile cylinders and for installation on new doors. Together with ARIES electronic trim set, LIBRA represents a complete range fulfilling any need for access control management both for community and residential environment (shopping malls, industries, public and private offices, schools and universities, hospitals and retirement homes, residences and hotels, etc.).

### Key points

The electronic cylinder LIBRA can be installed in most of the doors equipped with an European profile cylinder hole (EN1303).

It is battery operated, so it doesn't require any electrical external cabling. The result is the best flexibility and cost effectiveness of installation, both in new doors and in retrofitting.

The high modularity of the cylinder, obtained thanks to its patented design, drastically reduces the number of components required to build all the versions and measures necessary to cover the wide range of potential installations, with consequent reduction of components stocks, better flexibility and fast reaction to customer requests.

The unique and innovative design, combined with the finishes and colors available, allows the smooth integration in any architectural contexts.

### Main function

- Multistandard RFID Reader (ISO14443A/ISO14443B/NFC 13,56MHz).
- Wake up by RFID card or phone detection (patented) or Real Time Clock.
- Low consumption battery operated.
- Permanently open mode (office mode) without extra battery consumption.
- Batteries voltage monitoring.
- Real Time Clock/Calendar.
- Compact size and innovative design.
- Compatible with all the mechanical locks equipped with an European profile cylinder hole (EN1303, DIN 18252).
- Very easy and quick installation.
- Heavy Duty version with drilling protection over cylinder core and IP66/IP67/IP69 grading.
- Optical and acoustic signalling.
- On-site software upgrading.
- 4 finishes and 2 colors.

## **Libra**

---

### Technical features:

#### RFID Reader:

- Multistandard 13,56 Mhz:
  - ISO14443A (Mifare Classic, Plus, Desfire)
  - ISO14443B (i.e. ST microprocessor cards)
  - NFC (card emulation and Peer-to-Peer)

#### Communication interface:

- RFID Near Field Magnetic communication.

#### Main batteries:

- 1 X 2/3A ER17335M 3.6Vcc lithium battery
- Battery replacement from outside with door closed.

#### Battery life (endurance):

- Up to 5 years (\*)
- Up to 50.000 opening (\*)
- 3 levels battery charge detection

#### Signalling:

- LEDs: 1 Green, 1 Red visible on 360° ring
- Buzzer

#### Software:

- "Sirio" management software version available
- "Simply" version available
- OEM development platform available
- On-site software upgrading

#### Finishes (metal part):

- Inox
- Polished Inox
- Satin brass
- Polished brass

#### Colors (plastic parts):

- Glossy black
- Glossy white
- Special colors on request

#### Mechanical lockcase compatibility:

- Euro profile cylinder hole (EN1303, DIN18252)

#### Door thickness:

- Up to 120 mm (standard execution)
- Up to 140 mm (special execution)

#### Environmental characteristics:

- Operating temperature: -20°C ÷ +70°C
- Storage temperature: -25°C ÷ +75°C
- Protection system (IP grading): IP54 (IP66/IP67/IP69 for Heavy Duty version)

#### Electronic knob dimensions:

- External diameter: from 36 mm to 39 mm
- Length: 46 mm

#### Mechanic knob "Standard" dimensions:

- External diameter: 30 mm
- Length: 31 mm

## Libra

Mechanic knob "Premium" dimensions:

- External diameter: from 36 mm to 39 mm
- Length: 46 mm

Stator dimensions (double knob version):

- Minimum 30-30 mm
- Steps 5 mm
- Maximum total length 140 mm

Stator dimensions (half cylinder version):

- Minimum 30-10 mm
- Steps 5 mm
- Maximum 90-10 mm

### Options and versions:

- Electronic knob outside and mechanic "Standard" knob inside;
- Electronic knob outside and mechanic "Premium" knob inside;
- Electronic knob outside and electronic knob inside;
- Half cylinder with electronic knob outside;
- Panic locks version (on request);
- Internal usage version (IP54)
- Heavy Duty external usage All-Weather version (IP66 and maximum burglary protection)
- Radio communication module (\*\*).

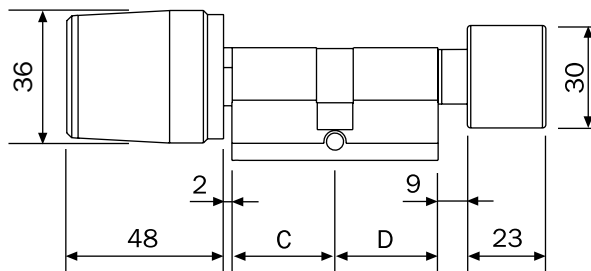

C= 30/35/40/45/50/55/60/65/70/75/80/85/90  
D= 30/35/40/45/50/55/60/65/70/75/80/85/90

(\*) Depending on usage, environment, options.

(\*\*) Available starting from the second half of 2014.

## Libra Premium

### ELECTRONIC CYLINDER WITH RFID READER AND “PREMIUM” MECHANICAL KNOB

Multistandard RFID Reader (ISO14443A/ISO14443B/NFC 13,56MHz) on outside  
“Premium” mechanical knob on internal side. Maximal body length 120 mm.

European profile and DIN cam. 6 finishes available.

Internal usage (IP54) and external usage (IP66 Heavy Duty) versions.

“SIMPLY” or “OFF-LINE” software.

Package: 1 cylinder, cylinder fixing screw M5 L=85 mm, 2 mm hex key, instruction sheet

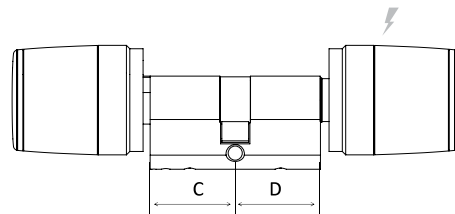

Coding

8 2 K **X** 0 **X X** **X X** **X X** 1 **X**

External usage version (IP66 Heavy Duty) **1**  
Internal usage version (IP54) **2**

DIMENSION DIMENSION

C D

30	30
35	35
40	40
45	45
50	50
55	55
60	60
65	65
70	70
75	75
80	80
85	85
90	90

L max 120 mm\*

FINISHES

25	Inox - Black
K5	Polished Chrome - Black
S5	Satin brass - Black
L5	Polished Brass - Black
K4	Polished Chrome - White
L4	Polished Brass - White

**1** Software SIMPLY  
**2** Software OFFLINE

#### Example

For internal usage (IP54)  
SIMPLY software  
Finish: Inox - Black  
Dimension C=30 mm  
Dimension D=50 mm

(\* bigger length on request)

Code 8 2 K 2 0 3 0 5 0 2 5 1 1

**Libra Standard**

**ELECTRONIC CYLINDER WITH RFID READER AND “STANDARD” MECHANICAL KNOB**

Multistandard RFID Reader (ISO14443A/ISO14443B/NFC 13,56MHz) on outside  
“Standard” mechanical knob on internal side. Maximal body length 120 mm

European profile and DIN cam. 6 finishes available.

Internal usage (IP54) and external usage (IP66 Heavy Duty) versions.

“SIMPLY” or “OFF-LINE” software.

Package: 1 cylinder, cylinder fixing screw M5 L=85 mm, 2 mm hex key, instruction sheet

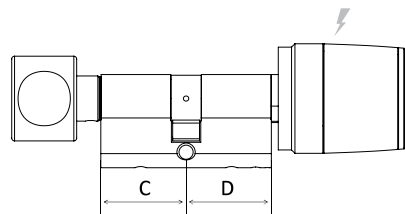

Coding

8 2 K **X** 8 **X X** **X X** **X X** 1 **X**

External usage version (IP66 Heavy Duty) **1**  
Internal usage version (IP54) **2**

DIMENSION	DIMENSION
C	D
30	30
35	35
40	40
45	45
50	50
55	55
60	60
65	65
70	70
75	75
80	80
85	85
90	90

L max 120 mm\*

FINISHES
<b>1</b> Software SIMPLY
<b>2</b> Software OFFLINE
<b>25</b> Inox - Black
<b>K5</b> Polished Chrome - Black
<b>S5</b> Satin brass - Black
<b>L5</b> Polished Brass - Black
<b>K4</b> Polished Chrome - White
<b>L4</b> Polished Brass - White

**Example**

For internal usage (IP54)  
Offline software  
Finish: Polished Chrome - Black  
Dimension C=40 mm  
Dimension D=50 mm

(\*) bigger length on request

Code 8 2 K **2 8 4 0 5 0 K 5 1 2**



## Libra Double

### ELECTRONIC CYLINDER WITH DOUBLE RFID READER

Multistandard RFID Readers (ISO14443A/ISO14443B/NFC 13,56MHz) on external side and internal side.

Maximal body length 120 mm. European profile and DIN cam.

6 finishes available. Internal usage (IP54) and external usage (IP66 Heavy Duty) versions.

**“SIMPLY” or “OFF-LINE” software.**

Package: 1 cylinder, cylinder fixing screw M5 L= 85 mm, 2 mm hex key, instruction sheet.

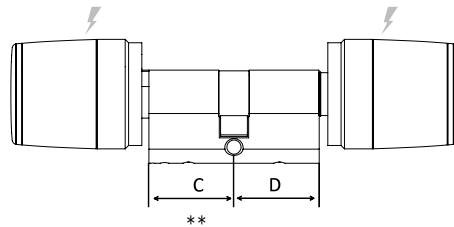

Coding

8 2 K X E X X X X X 1 X

External usage version (IP66 Heavy Duty) **1**

Internal usage version (IP54) **2**

DIMENSION

C

30

35

40

45

50

55

60

65

70

75

80

85

90

DIMENSION

D

30

35

40

45

50

55

60

65

70

75

80

85

90

FINISHES

**25** Inox - Black

**K5** Polished Chrome - Black

**S5** Satin brass - Black

**L5** Polished Brass - Black

**K4** Polished Chrome - White

**L4** Polished Brass - White

**1** Software SIMPLY

**2** Software OFFLINE

L max 120 mm\*

#### Example

For external usage (IP66 Heavy Duty)

SIMPLY software

Finish: Polished Brass - Black

Dimension C=30 mm

Dimension D=40 mm

Code 8 2 K **1 E 3 0 4 0 L 5 1 1**

(\*) bigger length on request

(\*\*) **C** = the side with removable electronic knob.

**Libra** Half

**ELECTRONIC HALF CYLINDER WITH RFID READER.**

Multistandard RFID Reader (ISO14443A/ISO14443B/NFC 13,56MHz).

Maximal body length 100 mm. European profile and DIN cam.

6 finishes available. Internal usage (IP54) and external usage (IP66 Heavy Duty) versions.

**“SIMPLY” or “OFF-LINE” software.**

Package: 1 cylinder, cylinder fixing screw M5 L = 85 mm, 2 mm hex key, instruction sheet

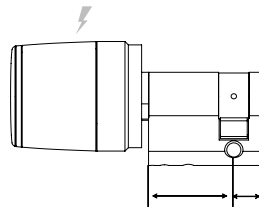

Coding

8 2 K **X** 0 **X X** **X X** **X X** 1 **X**

External usage version (IP66 Heavy Duty) **1**  
Internal usage version (IP54) **2**

DIMENSION DIMENSION

C D

**30**  
**35**  
**40**  
**45**  
**50**  
**55**  
**60**  
**65**  
**70**  
**75**  
**80**  
**85**  
**90**

L max 100 mm

FINISHES

**25** Inox - Black  
**K5** Polished Chrome - Black  
**S5** Satin brass - Black  
**L5** Polished Brass - Black  
**K4** Polished Chrome - White  
**L4** Polished Brass - White

**1** Software SIMPLY  
**2** Software OFFLINE

**Example**

For external usage (IP66 Heavy Duty)

SIMPLY software

Finish: Ottone lucido/Bianco

Dimension C=50 mm

Dimension D=10 mm

Code 8 2 K **1 0 5 0 1 0 L 4 1 1**

Package

Code

## Libra

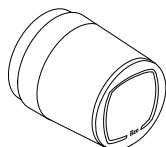

### “PREMIUM” KNOB COVER

Suitable both for RFID reader knob and “Premium” mechanical knob.  
Package: 1 cover.

Inox - Black	2	<b>0444025</b>
Polished Chrome - Black	2	<b>04440K5</b>
Satin brass - Black	2	<b>04440S5</b>
Polished brass - Black	2	<b>04440L5</b>
Polished Chrome - White	2	<b>04440K4</b>
Polished brass - White	2	<b>04440L4</b>



### ADAPTER FOR MECHANICAL PREMIUM KNOB

Allow the usage of the Premium covers as mechanical inside knobs.  
Package: 1 adaptor, 1 fixing screw.

10 **044240**

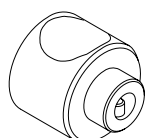

### “STANDARD” MECHANICAL KNOB

Inside mechanical knob.  
Package: 1 knob, 1 fixing screw.

Inox	10	<b>044232</b>
Polished Chrome	10	<b>04423K</b>
Satin Brass	10	<b>04423S</b>
Polished Brass	10	<b>04423L</b>

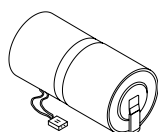

### BATTERY

High current lythium battery with connecting cable.  
Size 2/3 AA, 3.6 Vcc.  
Package: 1 battery

10 **003091**

Package

Code

## Libra

---

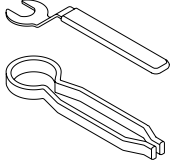

### **COVER ASSEMBLY/DISASSEMBLY TOOLING KIT FOR ELECTRONIC KNOB COVER**

Necessary for battery replacement  
Package: 1 wrench, 1 plier, instruction sheet

PLEASE NOTE: the cylinders are delivered WITHOUT these toolings. Please remember to order them separately.

---

1

**003092**

---

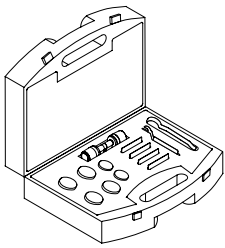

### **DEMO KIT SIMPLY SOFTWARE VERSION.**

Electronic cylinder with RFID reader and Premium mechanical knob.  
Covers in various finishes. Standard mechanical knob.  
SIMPLY system Cards Set.  
Assembly/disassembly wrench and plier.  
Demo Kit instruction sheet.

---

1

**003048**

---

## 1 - Field of application

These general terms of sale are intended to regulate the present and future sale contracts between the parties with the exception of any different conditions agreed in writing. Any general term established by the Buyer shall not be applied to the parties' future relationships unless agreed in writing. The Buyer's acceptance of FIAM's offer or order confirmation, however made, shall imply the application of these general terms of sale to the sale contract.

## 2 - Information data

The product features, prices and other data shown in FIAM's catalogues, price lists or any other documents as well as the features of samples and prototypes sent to the Buyer shall not be binding unless expressly mentioned in FIAM's offer or order confirmation.

FIAM reserves the right to make any necessary changes to their products in any moment. Any technical drawing or document given to the Buyer, which allows the manufacturing or assembly of the products or their parts, is property of FIAM. It cannot be used, copied, transmitted or communicated by the Buyer to a third party unless previously agreed with FIAM.

## 3 - Orders

Only written orders shall be accepted through an order confirmation.

Any offer made by FIAM's agents or representatives shall not be binding for FIAM until written confirmation of the latter.

For single orders with an amount lower than:

Italy	550,00 euro
EU	1.550,00 euro
Non-EU countries	3.000,00 euro

the following fixed operating expenses shall be invoiced:

Italy	25,00 euro
EU	78,00 euro

## 4 - Delivery

The delivery terms are:

<b>Italy</b>	Carriage Paid
<b>EU countries</b>	Carriage Paid
<b>Non-EU countries</b>	F.O.B. (Incoterms 2000)

The delivery terms are approximate in favour of FIAM with a fair tolerance margin. FIAM shall not be liable for any damage deriving from an anticipated, delayed or missing delivery, either full or partial. The risks connected to the supply shall pass on to the Buyer at the latest when the products leave FIAM's factory, unless the sale term or the applicable regulations provide for an earlier time.

## 5 - Prices – Payments

Prices, which include costs for packaging (packaging units are to be respected), shall be those in force at receipt of purchase order.

Payments, as well as any other amount payable to FIAM, shall be net at their premises. The Buyer shall not be entitled to suspend payments, even in case of disputes arising from supplied products.

Any payment dispute will entitle FIAM to suspend the manufacturing of the orders under execution and to ask the Buyer for suitable guarantees of payment and therefore to change the payment terms in force for future orders. No compensation with any credits towards FIAM shall be accepted.

For each invoice which will not have been paid by the due date, we will calculate accrued interest on arrears, by applying the official interest rate in force, according to D.LGS N. 192/2012 - implementation of Directives 2000/35/CE and 2011/7/UE. The supplied products shall remain FIAM's property until the full payment. To this end the Buyer shall undertake to do everything possible to grant in the Country where products are stocked a valid reservation of proprietary rights, or to put into force a warranty in favour of FIAM.

## 6 - Warranty

No returned product shall be accepted unless previously agreed with FIAM by filling in the return authorization request form. FIAM guarantees the conformity of the products with the legislation and technical standards in force in Italy.

Therefore, the buyer shall take the risk of eventual differences between Italian standards and the standards of the Country of destination of the products. FIAM guarantees the performance of their products only in relation to their stated use and application.

Any other use is considered as improper.

Should the Buyer resell these products, he shall be fully responsible to give his customers, at his own expenses, all the relevant information. The warranty is not valid in the following cases: products installation and/or use and/or maintenance not complying with FIAM instructions, modifications and/or repair without written authorization by FIAM, normal wear and tear.

FIAM's mechanical products are guaranteed for **10 years** against any engineering, material or manufacturing failures attributable to FIAM, provided they are properly used and installed. The electronic products and door closers are guaranteed for **3 years** from the date on the product label. In the absence of the label, the warranty declines unconditionally. Any replacement of components do not give rise to an extension of the warranty period for the whole product.

Claims shall be made in writing, on pain of forfeiture, within 8 days from the receipt of the goods for failures relating to quantity or for failures which could be

detected by the Buyer when receiving the goods; within 8 days from the discovery of hidden failures or non-conformities. Failures shall be exclusively assessed by FIAM's experts.

No claim against FIAM shall be accepted after the expiry of the warranty period. The Buyer shall lose the warranty right if payments are not regular. This warranty is limited to the replacement of the faulty part EXW FIAM.

No other reimbursement shall be made such as disassembly and assembly charges.

This warranty includes and replaces any other legal warranty for failures and conformity and excludes any other liability of FIAM connected to the supplied goods. Unless in case of fraud or gross negligence grave offence on the part of FIAM, the latter shall not be liable for direct, indirect or consequential damages to the buyer of the supplied products. In particular, the Buyer shall not be entitled to claim a damage refund, a price reduction or contract termination.

## 7 - User Licence agreement

### Important

Please read carefully this end user License agreement. The installation or use of any software shown in this catalogue means that you accept the terms and conditions of the following agreement.

### Ownership

ISEO SERRATURE S.P.A. (hereinafter ISEO), headquartered in Pisogne (BS), Via San Girolamo 13, and the productive or distribution companies of ISEO Group (hereinafter ISEO), as the only and exclusive owners, bestow the non-exclusive user license of any software contained in ISEO Zero1 product range, under the conditions described in the following paragraphs. The license is not a sale of the software and no expression contained in the license shall be construed to transfer any right or ownership.

### License concession

ISEO grants the right to use one copy of the software on the type of computer and operating system for which the software was designed to work. ISEO recognizes the rights to make backup copies only for security and archiving.

### Limitations on the right of use

The licensee is not authorized to rent, lease, share or to lend the software. The licensee is also not authorized to examine, modify, incorporate into another program, convert back to the original source code, decompile, disassemble or reverse engineer of the software.

The licensee is not authorized to remove, change or obscure the brand Iseo or indications relating to the entitlement. ISEO shall be informed and agree on any variation of the above mentioned limitations.

### Warranty

ISEO does not warrant that the operation of the software will be free from failures or that defects in the software will be corrected. ISEO ensures that the software is compliant with the technical and functional characteristics described in the supporting documentation. ISEO will use reasonable efforts to intervene in case of any malfunction up to 12 months after the invoice.

### Confidentiality

With the acceptance of this license, the licensee agrees to use the software only within his organization and not to assign or otherwise make the software, the technical knowledge of the program and supporting documentation available to third parties. The use of the software is closely related and limited Iseo in projects and products or correlated projects if previously agreed and authorized in writing by ISEO.

### Copyright

The software is the exclusive property of ISEO and is protected by Italian law on copyright, by the rules contained in international treaties and by the laws in force in the country in which it is used. Third party's software, software tools, compilers, assemblers, debuggers, operating systems and any other software are included or used in conjunction with ISEO software. Copyright and any correlated licenses are indicated in technical manuals.

### Limitation of liability and exclusion of damages

In no event will ISEO be responsible for any consequence, indirect, incidental or of any kind, including lost profits, business interruption, lost information, or other losses, arising out of the use or inability to use the software, even if ISEO has been advised on the eventuality of such damages.

Iseo responsibility for any direct damages to you or any third party will be in any event limited to gross negligence or willful misconduct.

## 8 - Competent Court – Applicable law

Any dispute arising from or connected with the contracts to which these general terms apply will be exclusively dealt with by the Court of Como; FIAM shall however be entitled to take legal action also before the Buyer's Court.

These general terms of sale are regulated by the Italian Law.

# ISEO Zero1

## ITALY

c/o: **Fiam** srl - Via Don Fasola 4  
I-22069 Rovellasca (CO)  
zero1-it@iseo.com  
iseozero1@iseo.com



## GERMANY

**ISEO Deutschland** GmbH  
zero1-de@iseo.com



## FRANCE

**ISEO France** s.a.s.  
zero1-fr@iseo.com  
+33 1 64835858

## SPAIN

**Cerraduras ISEO Ibérica** S.L.  
zero1-es@iseo.com



## ASIA

**ISEO Asia Pacific** SDN. BHD.  
zero1-asia@iseo.com  
+603 80753331

## ISEO Beijing

zero1-cn@iseo.com  
+8610 58698079

## UNITED ARAB EMIRATES

**ISEO Middle East** F.Z.E.  
zero1-me@iseo.com  
+971 4 2957220

## SOUTH AFRICA

**ISEO South Africa** (Pty) LTD  
zero1-za@iseo.com

**ISEO**<sup>®</sup>  
[www.iseo.com](http://www.iseo.com)

**ISEO Serrature** s.p.a.  
Via San Girolamo 13  
I-22055 Pisogne (BS)  
iseo@iseo.com

**ISEO zero1**  
ELECTRONIC  
SOLUTIONS

[iseozero1.com](http://iseozero1.com)