

Padlocks

**Iustus
Aditus**

Code
Single
package
Multiple
package
Min. ord.

Iustus



Open shackle PADLOCK IUSTUS. **BODY MATERIAL: BRASS, MM 20.**
Chrome-plated steel Ø 3. **SHACKLE CLEARANCE MM 12. 2 KEYS.**

800207 1 12 12



Open shackle PADLOCK IUSTUS. **BODY MATERIAL: BRASS, MM 25.**
Chrome-plated steel shackle Ø 4. **SHACKLE CLEARANCE MM 15. 2 KEYS.**

800257 1 12 12

Open shackle PADLOCK IUSTUS. **BODY MATERIAL: BRASS, MM 25.**
Chrome-plated steel shackle Ø 4. **SHACKLE CLEARANCE MM 15. 2 KEYS. ISEO CODING.**

800257..K 1 12 12

Open shackle PADLOCK IUSTUS. **BODY MATERIAL: BRASS, MM 25.**
Chrome-plated steel shackle Ø 4. **SHACKLE CLEARANCE MM 15. 2 KEYS.**

Fixed coding 061	800257..K1	1	12	12
Fixed coding 062	800257..K2	1	12	12
Fixed coding 063	800257..K3	1	12	12
Fixed coding 064	800257..K4	1	12	12
Fixed coding 065	800257..K5	1	12	12

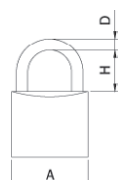

Open shackle PADLOCK IUSTUS. **BODY MATERIAL: BRASS, MM 30.**
Chrome-plated steel shackle Ø 5. **SHACKLE CLEARANCE MM 18. 2 KEYS.**

800307 1 12 12

Open shackle PADLOCK IUSTUS. **BODY MATERIAL: BRASS, MM 30.**
Chrome-plated steel shackle Ø 5. **SHACKLE CLEARANCE MM 18. 2 KEYS. ISEO CODING**

800307..K 1 12 12

Open shackle PADLOCK IUSTUS. **BODY MATERIAL: BRASS, MM 30.**
Chrome-plated steel shackle Ø 5. **SHACKLE CLEARANCE MM 18. 2 KEYS**

Fixed coding 2141	800307..K1	1	12	12
Fixed coding 2222	800307..K2	1	12	12
Fixed coding 2243	800307..K3	1	12	12
Fixed coding 2164	800307..K4	1	12	12
Fixed coding 2185	800307..K5	1	12	12

Open shackle PADLOCK IUSTUS. **BODY MATERIAL: BRASS, MM 40.**
Chrome-plated steel shackle Ø 6. **SHACKLE CLEARANCE MM 22. 2 KEYS.** Antipick disk.

800407 1 12 12

Open shackle PADLOCK IUSTUS. **BODY MATERIAL: BRASS, MM 40.**
Chrome-plated steel shackle Ø 6. **SHACKLE CLEARANCE MM 22. 2 KEYS.**
ISEO CODING. Antipick disk.

800407..K 1 12 12

Open shackle PADLOCK IUSTUS. **BODY MATERIAL: BRASS, MM 40.**
Chrome-plated steel shackle Ø 6. **SHACKLE CLEARANCE MM 22. 2 KEYS.**

Antipick disk.				
Fixed coding 3151	800407..K1	1	12	12
Fixed coding 3152	800407..K2	1	12	12
Fixed coding 3153	800407..K3	1	12	12
Fixed coding 3154	800407..K4	1	12	12
Fixed coding 3155	800407..K5	1	12	12

A	H	D
20	12	3
25	15	4
30	18	5
40	22	6
50	28	8
60	35	10
70	44	12

Iustus



A	H	D
20	12	3
25	15	4
30	18	5
40	22	6
50	28	8
60	35	10
70	44	12

	Code	Single package	Multiple package	Min. ord.
Open shackle PADLOCK IUSTUS. BODY MATERIAL: BRASS, MM 50. Chrome-plated steel shackle Ø 8. SHACKLE CLEARANCE MM 28. 2 KEYS. (KEY BLANK CODE: 020259). Antipick disk.	800507	1	10	10
Open shackle PADLOCK IUSTUS. BODY MATERIAL: BRASS, MM 50. Chrome-plated steel shackle Ø 8. SHACKLE CLEARANCE MM 28. 2 KEYS. (Key blank code: 020259). CODING ON REQUEST. Antipick disk.	800507..5	1	-	-
Open shackle PADLOCK IUSTUS. BODY MATERIAL: BRASS, MM 50. Chrome-plated steel shackle Ø 8. SHACKLE CLEARANCE MM 28. 2 KEYS. (Key blank code: 020259). ISEO CODING. Antipick disk.	800507..K	1	10	10
Open shackle PADLOCK IUSTUS. BODY MATERIAL: BRASS, MM 50. Chrome-plated steel shackle Ø 8. SHACKLE CLEARANCE MM 28. 2 KEYS. (Key blank code: 020259). Antipick disk.				
Fixed coding 4031	800507..K1	1	10	10
Fixed coding 4032	800507..K2	1	10	10
Fixed coding 4063	800507..K3	1	10	10
Fixed coding 4084	800507..K4	1	10	10
Fixed coding 4135	800507..K5	1	10	10
Open shackle PADLOCK IUSTUS. BODY MATERIAL: BRASS, MM 60. Chrome-plated steel shackle Ø 10. SHACKLE CLEARANCE MM 35. 2 KEYS. (Key blank code: 020259). Antipick disk.	800607	1	10	10
Open shackle IUSTUS padlock. BODY MATERIAL: BRASS, MM 60. Chrome-plated steel shackle Ø 10. SHACKLE CLEARANCE MM 35. 2 KEYS. (Key blank code: 020259). CODING ON REQUEST. Antipick disk.	800607..5	1	-	-
Open shackle PADLOCK IUSTUS. BODY MATERIAL: BRASS, MM 60. Chrome-plated steel shackle Ø 10. SHACKLE CLEARANCE MM 35. 2 KEYS. (Key blank code: 020259). ISEO CODING. Antipick disk.	800607..K	1	10	10
Open shackle PADLOCK IUSTUS. BODY MATERIAL: BRASS, MM 60. Chrome-plated steel shackle Ø 10. SHACKLE CLEARANCE MM 35. 2 KEYS. (KEY BLANK CODE: 020259). Antipick disk.				
Fixed coding 5081	800607..K1	1	10	10
Fixed coding 5082	800607..K2	1	10	10
Fixed coding 5193	800607..K3	1	10	10
Fixed coding 5204	800607..K4	1	10	10
Fixed coding 5215	800607..K5	1	10	10
Open shackle PADLOCK IUSTUS. BODY MATERIAL: BRASS, MM 70. Chrome-plated steel shackle Ø 12. SHACKLE CLEARANCE MM 44. 2 KEYS. (KEY BLANK CODE: 020259). Antipick disk.	800707	1	10	10
Open shackle PADLOCK IUSTUS. BODY MATERIAL: BRASS, MM 70. Chrome-plated steel shackle Ø 12. SHACKLE CLEARANCE MM 44. 2 KEYS. (Key blank code: 020259). CODING ON REQUEST. Antipick disk.	800707..5	1	-	-

Code
Single
Multiple
package
Min. ord.

Iustus



Open shackle PADLOCK IUSTUS. **BODY MATERIAL: BRASS, MM 70.**

Chrome-plated steel shackle Ø 12. **SHACKLE CLEARANCE MM 44. 2 KEYS.**

(Key blank code: 020259). **ISEO CODING.** Antipick disk.

800707..K 1 10 10



Open shackle PADLOCK IUSTUS. **BODY MATERIAL: BRASS, MM 70.** Chrome-plated steel

shackle Ø 12. **SHACKLE CLEARANCE MM 44. 2 KEYS.** (KEY BLANK CODE: 020259).

Antipick disk.

Fixed coding 6061

800707..K1 1 10 10

Fixed coding 6062

800707..K2 1 10 10

Fixed coding 6103

800707..K3 1 10 10

Fixed coding 6104

800707..K4 1 10 10

Fixed coding 6105

800707..K5 1 10 10

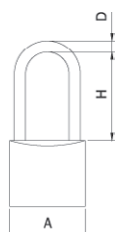

Long shackle PADLOCK IUSTUS. **BODY MATERIAL: BRASS, MM 25.**

Chrome-plated steel shackle Ø 4. **SHACKLE CLEARANCE MM 25. 2 KEYS.**

802257 1 12 12

Long shackle PADLOCK IUSTUS. **BODY MATERIAL: BRASS, MM 25.**

Chrome-plated steel shackle Ø 4. **SHACKLE CLEARANCE MM 25. 2 KEYS. ISEO CODING.**

802257..K 1 12 12

Long shackle PADLOCK IUSTUS. **BODY MATERIAL: BRASS, MM 30.**

Chrome-plated steel shackle Ø 5. **SHACKLE CLEARANCE MM 46. 2 KEYS.**

802307 1 12 12

Long shackle PADLOCK IUSTUS. **BODY MATERIAL: BRASS, MM 30.**

Chrome-plated steel shackle Ø 5. **SHACKLE CLEARANCE MM 46. 2 KEYS. ISEO CODING.**

802307..K 1 12 12

Long shackle PADLOCK IUSTUS. **BODY MATERIAL: BRASS, MM 30.**

Chrome-plated steel shackle Ø 5. **SHACKLE CLEARANCE MM 67. 2 KEYS.**

802317 1 12 12

Long shackle PADLOCK IUSTUS. **BODY MATERIAL: BRASS, MM 30.**

Chrome-plated steel shackle Ø 5. **SHACKLE CLEARANCE MM 67. 2 KEYS. ISEO CODING.**

802317..K 1 12 12

Long shackle PADLOCK IUSTUS. **BODY MATERIAL: BRASS, MM 30.**

Chrome-plated steel shackle Ø 5. **SHACKLE CLEARANCE MM 100. 2 KEYS.**

802327 1 12 12

Long shackle PADLOCK IUSTUS. **BODY MATERIAL: BRASS, MM 30.**

Chrome-plated steel shackle Ø 5. **SHACKLE CLEARANCE MM 100. 2 KEYS. ISEO CODING.**

802327..K 1 12 12

Long shackle PADLOCK IUSTUS. **BODY MATERIAL: BRASS, MM 40.**

Chrome-plated steel shackle Ø 6. **SHACKLE CLEARANCE MM 47. 2 KEYS.** Antipick disk.

802407 1 12 12

Long shackle PADLOCK IUSTUS. **BODY MATERIAL: BRASS, MM 40.** Chrome-plated steel

shackle Ø 6. **SHACKLE CLEARANCE MM 47. 2 KEYS.** Antipick disk. **ISEO CODING.**

802407..K 1 12 12

Long shackle PADLOCK IUSTUS. **BODY MATERIAL: BRASS, MM 40.** Chrome-plated

steel shackle Ø 6. **SHACKLE CLEARANCE MM 67. 2 KEYS.** Antipick disk.

802417 1 12 12

Long shackle PADLOCK IUSTUS. **BODY MATERIAL: BRASS, MM 40.** Chrome-plated

steel shackle Ø 6. **SHACKLE CLEARANCE MM 67. 2 KEYS. ISEO CODING.** Antipick disk.

802417..K 1 12 12

	A	H	D
25	25	25	4
30	30	46	5
31	30	67	5
40	40	47	6
41	40	67	6
50	50	50	8
51	50	67	8
52	50	90	8

Code
Single
package
Multiple
package
Min. ord.

Iustus



	A	H	D
32	30	100	5
42	40	90	6
50	50	50	8
51	50	67	8
53	50	152	8

Long shackle PADLOCK IUSTUS. BODY MATERIAL: BRASS, MM 40. Chrome-plated steel shackle Ø 6. SHACKLE CLEARANCE MM 90. 2 KEYS. Antipick disk.	802427	1	12	12
Long shackle PADLOCK IUSTUS. BODY MATERIAL: BRASS, MM 40. Chrome-plated steel shackle Ø 6. SHACKLE CLEARANCE MM 90. 2 KEYS. ISEO CODING. Antipick disk.	802427..K	1	12	12
Long shackle PADLOCK IUSTUS. BODY MATERIAL: BRASS, MM 50. Chrome-plated steel shackle Ø 8. SHACKLE CLEARANCE MM 50. 2 KEYS. (Key blank code: 020259). Antipick disk.	802507	1	10	10
Long shackle PADLOCK IUSTUS. BODY MATERIAL: BRASS, MM 50. Chrome-plated steel shackle Ø 8. SHACKLE CLEARANCE MM 50. 2 KEYS (Key blank code: 020259). CODING ON REQUEST. Antipick disk.	802507..5	1	-	-
Long shackle PADLOCK IUSTUS. BODY MATERIAL: BRASS, MM 50. Chrome-plated steel shackle Ø 8. ISEO CODING. SHACKLE CLEARANCE MM 50. 2 KEYS. (Key blank code: 020259). Antipick disk	802507..K	1	10	10
Long shackle PADLOCK IUSTUS. BODY MATERIAL: BRASS, MM 50. Chrome-plated steel shackle Ø 8. SHACKLE CLEARANCE MM 67. 2 KEYS. (Key blank code: 020259). Antipick disk.	802517	1	10	10
Long shackle PADLOCK IUSTUS. BODY MATERIAL: BRASS, MM 50. Chrome-plated steel shackle Ø 8. SHACKLE CLEARANCE MM 67. 2 KEYS. (Key blank code: 020259). CODING ON REQUEST. Antipick disk.	802517..5	1	-	-
Long shackle PADLOCK IUSTUS. BODY MATERIAL: BRASS, MM 50. Chrome-plated steel shackle Ø 8. SHACKLE CLEARANCE MM 67. 2 KEYS. (Key blank code: 020259). ISEO CODING. Antipick disk.	802517..K	1	10	10
Long shackle PADLOCK IUSTUS. BODY MATERIAL: BRASS, MM 50. Chrome-plated steel shackle Ø 8. SHACKLE CLEARANCE MM 90. 2 KEYS. (Key blank code: 020259). Antipick disk.	802527	1	10	10
Long shackle PADLOCK IUSTUS. BODY MATERIAL: BRASS, MM 50. Chrome-plated steel shackle Ø 8. SHACKLE CLEARANCE MM 90. 2 KEYS. (Key blank code: 020259). CODING ON REQUEST. Antipick disk.	802527..5	1	-	-
Long shackle PADLOCK IUSTUS. BODY MATERIAL: BRASS, MM 50. Chrome-plated steel shackle Ø 8. SHACKLE CLEARANCE MM 90. 2 KEYS. (Key blank code: 020259). ISEO CODING. Antipick disk.	802527..K	1	10	10
Long shackle PADLOCK IUSTUS. BODY MATERIAL: BRASS, MM 50. Chrome-plated steel shackle Ø 8. SHACKLE CLEARANCE MM 152. 2 KEYS. (Key blank code: 020259). Antipick disk.	802537	1	10	10
Long shackle PADLOCK IUSTUS. BODY MATERIAL: BRASS, MM 50. Chrome-plated steel shackle Ø 8. SHACKLE CLEARANCE MM 152. 2 KEYS. (Key blank code: 020259). CODING ON REQUEST. Antipick disk.	802537.5	1	-	-
Long shackle PADLOCK IUSTUS. BODY MATERIAL: BRASS, MM 50. Chrome-plated steel shackle Ø 8. SHACKLE CLEARANCE MM 152. 2 KEYS. (Key blank code: 020259). ISEO CODING. Antipick disk.	802537..K	1	10	10

Code
Single
package
Multiple
package
Min. ord.

Iustus



RECTANGULAR PADLOCK IUSTUS for gates. **BRASS BODY MM 70.**
Shaft material: chrome-plated carbonitrided steel Ø 12, opening grip.
Shaft ball-locking. **SHAFT CLEARANCE MM 20X15.**
2 KEYS. (Key blank code: 020259)

804707 1 6 6



RECTANGULAR PADLOCK IUSTUS for gates. **BRASS BODY MM 70.**
Shaft material: chrome-plated carbonitrided steel Ø 12, opening grip.
Shaft ball-locking. **SHAFT CLEARANCE MM 20X15.**
2 KEYS. (Key blank code: 020259). **CODING ON REQUEST.**

804707.5 1 6 1

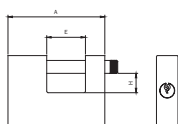

RECTANGULAR PADLOCK IUSTUS for gates. **BRASS BODY MM 70.**
Shaft material: chrome-plated carbonitrided steel Ø 12, opening grip.
Shaft ball-locking. **SHAFT CLEARANCE MM 20X15.**
2 KEYS. (Key blank code: 020259). **ISEO CODING.**

804707..K 1 6 6

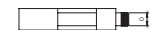

A	E	H	D
70	20	15	12
90	36	18	12

RECTANGULAR PADLOCK IUSTUS for gates. **BRASS BODY MM 90.**
Shaft material: chrome-plated carbonitrided steel Ø 12, opening grip.
Shaft ball-locking. **SHAFT CLEARANCE MM 36X18.**
2 KEYS. (Key blank code: 020259).

804907 1 6 6

RECTANGULAR PADLOCK IUSTUS for gates. **BRASS BODY MM 90.**
Shaft material: chrome-plated carbonitrided steel Ø 12, opening grip.
Shaft ball-locking. **SHAFT CLEARANCE MM 36X18.**
2 KEYS. (Key blank code: 020259). **CODING ON REQUEST.**

804907.5 1 6 1

RECTANGULAR PADLOCK IUSTUS for gates. **BRASS BODY MM 90.**
Shaft material: chrome-plated carbonitrided steel Ø 12, opening grip.
Shaft ball-locking. **SHAFT CLEARANCE MM 36X18.**
2 KEYS. (Key blank code: 020259). **ISEO CODING.**

804907..K 1 6 6



RECTANGULAR **ARMOURED** PADLOCK IUSTUS for gates. **BRASS BODY MM 90.**
Armour material: chrome-plated, carbonitrided steel. Shaft material: chrome-plated carbonitrided steel Ø 12, opening grip, Shaft ball-locking.
SHAFT CLEARANCE MM 36X18. 2 KEYS. (Key blank code: 020259).

805909 1 6 6



RECTANGULAR **ARMOURED** PADLOCK IUSTUS for gates. **BRASS BODY MM 90.**
Armour material: chrome-plated, carbonitrided steel. Shaft material: chrome-plated carbonitrided steel Ø 12, opening grip, Shaft ball-locking. **SHAFT CLEARANCE MM 36X18.**
2 KEYS. (Key blank code: 020259). **CODING ON REQUEST**

805909.5 1 6 1

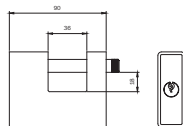

RECTANGULAR **ARMOURED** PADLOCK IUSTUS for gates. **BRASS BODY MM 90.**
Armour material: chrome-plated, carbonitrided steel. Shaft material: chrome-plated carbonitrided steel Ø 12, opening grip, Shaft ball-locking.
SHAFT CLEARANCE MM 36X18. 2 KEYS. (Key blank code: 020259). **ISEO CODING.**

805909..K 1 6 6



Code
Single
package
Multiple
package
Min. ord.

Iustus



RECTANGULAR padlock BOXER, **FULLY ARMoured**, for gates. Body material: Zamak.
Armour material: chrome-plated carbonitrided steel mm 90. It operates with European single-profile cylinder **F5** mm 40 (30+10), supplied with projecting cam art. 820930107.
Stainless steel shaft Ø 12, opening grip. Shaft ball-locking. **SHAFT CLEARANCE MM 36X17,5**.
When the padlock is open the armour can be removed to replace the cylinder.
3 KEYS. (key blank code: 020259).

809909 1 - 1

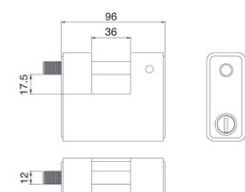

RECTANGULAR padlock BOXER, **FULLY ARMoured**, for gates. Body material: Zamak.
Armour material: chrome-plated carbonitrided steel mm 90. It operates with European single-profile cylinder **F5** mm 40 (30+10), supplied with projecting cam art. 820930107.
Stainless steel shaft Ø 12, opening grip. Shaft ball-locking. **SHAFT CLEARANCE MM 36X17,5**.
When the padlock is open the armour can be removed to replace the cylinder.
3 KEYS. (key blank code: 020259). **CODING ON REQUEST.**

809909..5 1 - 1

RECTANGULAR padlock BOXER, **FULLY ARMoured**, for gates. Body material: Zamak.
Armour material: chrome-plated carbonitrided steel mm 90. It operates with European single-profile cylinder **F5** mm 40 (30+10), supplied with projecting cam art. 820930107.
Stainless steel shaft Ø 12, opening grip. Shaft ball-locking. **SHAFT CLEARANCE MM 36X17,5**.
When the padlock is open the armour can be removed to replace the cylinder.
3 KEYS. (key blank code: 020259). **ISEO CODING.**

809909..K 1 - 1



RECTANGULAR padlock BOXER, **FULLY ARMoured**, for gates. Body material: Zamak.
Armour material: chrome-plated carbonitrided steel mm 90.
It operates with European single-profile cylinder **F6** mm 40 (30+10), supplied with projecting cam art. 810930107. Stainless steel shaft Ø 12, opening grip. Shaft ball-locking.
SHAFT CLEARANCE MM 36X17,5. When the padlock is open the armour can be removed to replace the cylinder. **3 KEYS.** (key blank code: 020609).

809909..F6 1 - 1



RECTANGULAR padlock BOXER, **FULLY ARMoured**, for gates. Body material: Zamak.
Armour material: chrome-plated carbonitrided steel mm 90.
It operates with European single-profile cylinder **R6 New** mm 40 (30+10), supplied with off-center cam art. 880930109. Stainless steel shaft Ø 12, opening grip. Shaft ball-locking.
SHAFT CLEARANCE MM 36X17,5. When the padlock is open the armour can be removed to replace the cylinder. **3 KEYS.** (key blank code: 020839).

809909.R6 1 - 1

RECTANGULAR padlock BOXER, **FULLY ARMoured**, for gates. Body material: Zamak.
Armour material: chrome-plated carbonitrided steel mm 90. It operates with European single-profile cylinder **R6 New**, mm 40 (30+10), supplied with projecting cam art. 880930109.8. Stainless steel shaft Ø 12, opening grip. Shaft ball-locking.
SHAFT CLEARANCE MM 36X17,5. When the padlock is open the armour can be removed to replace the cylinder. **3 KEYS.** (key blank code: 020809). **CODING ON REQUEST.**

809909.8R6 1 - 1

RECTANGULAR padlock BOXER, **FULLY ARMoured**, for gates. Body material: Zamak.
Armour material: chrome-plated carbonitrided steel mm 90. It operates with European single-profile cylinder **R6 New** mm 40 (30+10), supplied with projecting cam art. 880930109.
Stainless steel shaft Ø 12, opening grip. Shaft ball-locking. **SHAFT CLEARANCE MM 36X17,5**.
When the padlock is open the armour can be removed to replace the cylinder.
3 KEYS. (key blank code: 020809). **ISEO CODING.**

809909..KR6 1 - 1

Code
Single
package
Multiple
package
Min. ord.

Iustus



RECTANGULAR padlock BOXER, **FULLY ARMoured**, for gates. Body material: Zamak.
Armour material: chrome-plated carbonitrided steel mm 90. It operates with European single-profile cylinder **R7** mm 40 (30+10), supplied with projecting cam art.89R7030109. Stainless steel shaft Ø 12, opening grip. Shaft ball-locking.

SHAFT CLEARANCE MM 36X17,5. When the padlock is open the armour can be removed to replace the cylinder. **3 KEYS.** (key blank code: 020909).

809909..R7 1 - 1

RECTANGULAR padlock BOXER, **FULLY ARMoured**, for gates. Body material: Zamak.
Armour material: chrome-plated carbonitrided steel mm 90.

It operates with European single-profile cylinder **R7** mm 40 (30+10), supplied with projecting cam art.89R7030109.8. Stainless steel shaft Ø 12, opening grip Shaft ball-locking.

SHAFT CLEARANCE MM 36X17,5. When the padlock is open the armour can be removed to replace the cylinder. **3 KEYS.** (key blank code: 020909). **CODING ON REQUEST.**

809909.8R7 1 - 1

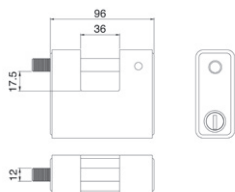

RECTANGULAR padlock BOXER, **FULLY ARMoured**, for gates. Body material: Zamak.
Armour material: chrome-plated carbonitrided steel mm 90. It operates with European single-profile cylinder **R7** mm 40 (30+10), supplied with projecting cam art.89R7030109.8. Stainless steel shaft Ø 12, opening grip. Shaft ball-locking.

SHAFT CLEARANCE MM 36X17,5. When the padlock is open the armour removed to replace the cylinder. **3 KEYS.** (key blank code: 020909). **ISEO CODING.**

809909.KR7 1 - 1



RECTANGULAR padlock BOXER, **FULLY ARMoured**, for gates. Body material: Zamak.
Armour material: chrome-plated carbonitrided steel mm 90. It operates with European single-profile cylinder mm 40 (30+10) projecting cam. Stainless steel shaft Ø 12, opening grip. Shaft ball-locking. **SHAFT CLEARANCE MM 36X17,5.**

When the padlock is open the armour can be removed to replace the cylinder.

809909I 1 - 1

Aditus

Code
Single package
Multiple package
Min. ord.



Open-shackle PADLOCK ADITUS. **BODY: SATIN POLISHED BRASS MM 20.** Tempered and chrome-plated steel shackle Ø 3,5. **SHACKLE CLEARANCE MM 10. 2 KEYS** **P00020127** 1 12 12



Open-shackle PADLOCK ADITUS. **BODY: SATIN POLISHED BRASS MM 20.** Tempered and chrome-plated steel shackle Ø 3,5. **SHACKLE CLEARANCE MM 10. 2 KEYS. ISEO CODING.** **P00020127.K** 1 12 12

Open-shackle PADLOCK ADITUS. **BODY: SATIN POLISHED BRASS MM 25.** Tempered and chrome-plated steel shackle Ø 4,2. **SHACKLE CLEARANCE MM 15,5. 2 KEYS** **P00025157** 1 12 12

Open-shackle PADLOCK ADITUS. **BODY: SATIN POLISHED BRASS MM 25.** Tempered and chrome-plated steel shackle Ø 4,2. **SHACKLE CLEARANCE MM 15,5. 2 KEYS ISEO CODING.** **P00025157.K** 1 12 12

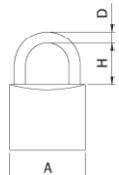

Open-shackle PADLOCK ADITUS. Body: satin polished brass mm 25. Tempered and chrome-plated steel shackle Ø 4,2. **SHACKLE CLEARANCE MM 25. 2 KEYS** **P00025257** 1 12 12

Open-shackle PADLOCK ADITUS. **BODY: SATIN POLISHED BRASS MM 25.** Tempered and chrome-plated steel shackle Ø 4,2. **SHACKLE CLEARANCE MM 25. 2 KEYS. ISEO CODING.** **P00025257.K** 1 12 12

	A	H	D
P00020127	20	10	3,5
P00025157	25	15,5	4,2
P00025257	25	25	4,2
P00030167	30	16	5,1
P00030467	30	46	5,1
P00040217	40	23,9	5,1
P00040477	40	47	6,3
P00040707	40	70	6,3
P00050277	50	29,5	8,0
P00050507	50	50	8,0
P00060377	60	37,5	9,5
P00070427	70	41	11

Open-shackle PADLOCK ADITUS. **BODY: SATIN POLISHED BRASS MM 30.** Tempered and chrome-plated steel shackle Ø 5,1. **SHACKLE CLEARANCE MM 16. 2 KEYS** **P00030167** 1 12 12

Open-shackle PADLOCK ADITUS. **BODY: SATIN POLISHED BRASS MM 30.** Tempered and chrome-plated steel shackle Ø 5,1. **SHACKLE CLEARANCE MM 16. 2 KEYS ISEO CODING.** **P00030167.K** 1 12 12

Open-shackle PADLOCK ADITUS. **BODY: SATIN POLISHED BRASS MM 30.** Tempered and chrome-plated steel shackle Ø 5,1. **SHACKLE CLEARANCE MM 46. 2 KEYS** **P00030467** 1 12 12

Open-shackle PADLOCK ADITUS. **BODY: SATIN POLISHED BRASS MM 30.** Tempered and chrome-plated steel shackle Ø 5,1. **SHACKLE CLEARANCE MM 46. 2 KEYS ISEO CODING.** **P00030467.K** 1 12 12



Open-shackle PADLOCK ADITUS. **BODY: SATIN POLISHED BRASS MM 40.** Tempered and chrome-plated steel shackle Ø 6,3. **SHACKLE CLEARANCE MM 23,9. 2 KEYS** **P00040217** 1 12 12



Open-shackle PADLOCK ADITUS. **BODY: SATIN POLISHED BRASS MM 40.** Tempered and chrome-plated steel shackle Ø 6,3. **SHACKLE CLEARANCE MM 23,9. 2 KEYS. ISEO CODING.** **P00040217.K** 1 12 12

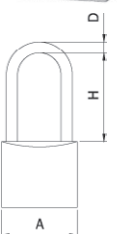

Aditus

Code
Single
Multiple
package
Min. ord.



Open-shackle PADLOCK ADITUS. **BODY: SATIN POLISHED BRASS MM 40.** Tempered and chrome-plated steel shackle \varnothing 6,3. **SHACKLE CLEARANCE MM 47. 2 KEYS** **P00040477** 1 12 12

Open-shackle PADLOCK ADITUS. **BODY: SATIN POLISHED BRASS MM 40.** Tempered and chrome-plated steel shackle \varnothing 6,3. **SHACKLE CLEARANCE MM 47. 2 KEYS. ISEO CODING.** **P00040477.K** 1 12 12

Open-shackle PADLOCK ADITUS. **BODY: SATIN POLISHED BRASS MM 40.** Tempered and chrome-plated steel shackle \varnothing 6,3. **SHACKLE CLEARANCE MM 70. 2 KEYS** **P00040707** 1 12 12

Open-shackle PADLOCK ADITUS. **BODY: SATIN POLISHED BRASS MM 50.** Tempered and chrome-plated steel shackle \varnothing 8. **SHACKLE CLEARANCE MM 29,5 2 KEYS.** **P00050277** 1 6 6

Open-shackle PADLOCK ADITUS. **BODY: SATIN POLISHED BRASS MM 50.** Tempered and chrome-plated steel shackle \varnothing 8. **SHACKLE CLEARANCE MM 29,5. 2 KEYS. ISEO CODING.** **P00050277.K** 1 6 6

Open-shackle PADLOCK ADITUS. **BODY: SATIN POLISHED BRASS MM 50.** Tempered and chrome-plated steel shackle \varnothing 8. **SHACKLE CLEARANCE MM 50. 2 KEYS.** **P00050507** 1 6 6

Open-shackle PADLOCK ADITUS. **BODY: SATIN POLISHED BRASS MM 50.** Tempered and chrome-plated steel shackle \varnothing 8. **SHACKLE CLEARANCE MM 50. 2 KEYS. ISEO CODING.** **P00050507.K** 1 6 6

Open-shackle PADLOCK ADITUS. **BODY: SATIN POLISHED BRASS MM 60.** Tempered and chrome-plated steel shackle \varnothing 9,5. **SHACKLE CLEARANCE MM 37,5. 2 KEYS.** **P00060377** 1 6 6

Open-shackle PADLOCK ADITUS. **BODY: SATIN POLISHED BRASS MM 60.** Tempered and chrome-plated steel shackle \varnothing 9,5. **SHACKLE CLEARANCE MM 37,5. 2 KEYS. ISEO CODING.** **P00060377.K** 1 6 6

Open-shackle PADLOCK ADITUS. **BODY: SATIN POLISHED BRASS MM 70.** Tempered and chrome-plated steel shackle \varnothing 11. **SHACKLE CLEARANCE MM 41. 2 KEYS.** **P00070427** 1 6 6

Open-shackle PADLOCK ADITUS. **Body: satin polished brass mm 70.** Tempered and chrome-plated steel shackle \varnothing 11. **SHACKLE CLEARANCE MM 41. 2 KEYS. ISEO CODING.** **P00070427.K** 1 6 6

	A	H	D
P00020127	20	10	3,5
P00025157	25	15,5	4,2
P00025257	25	25	4,2
P00030167	30	16	5,1
P00030467	30	46	5,1
P00040217	40	23,9	5,1
P00040477	40	47	6,3
P00040707	40	70	6,3
P00050277	50	29,5	8,0
P00050507	50	50	8,0
P00060377	60	37,5	9,5
P00070427	70	41	11

Code
Single package
Multiple package
Min. ord.

Aditus



RECTANGULAR PADLOCK ADITUS for gates. **BODY: PAINTED SATIN BRASS MM 50.**

Shaft material: chrome-plated carbonitrided steel Ø 8.

Shaft ball-locking. **SHAFT CLEARANCE MM 15X12,5.**

2 KEYS.

P04050177 1 12 12



RECTANGULAR PADLOCK ADITUS for gates. **BODY: PAINTED SATIN BRASS MM 50.**

Shaft material: chrome-plated carbonitrided steel Ø 8. Shaft ball-locking.

SHAFT CLEARANCE MM 15X12,5.

2 KEYS. ISEO CODING.

P04050177.K 1 12 12

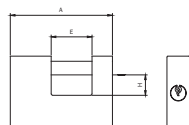

RECTANGULAR PADLOCK ADITUS for gates. **BODY: PAINTED SATIN BRASS MM 60.**

Shaft material: chrome-plated carbonitrided steel Ø 10. Shaft ball-locking.

SHAFT CLEARANCE MM 18X14

2 KEYS.

P04060187 1 6 6

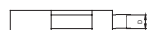

RECTANGULAR PADLOCK ADITUS for gates. **BODY: PAINTED SATIN BRASS MM 60.**

Shaft material: chrome-plated carbonitrided steel Ø 10. Shaft ball-locking.

SHAFT CLEARANCE MM 18X14

2 KEYS. ISEO CODING.

P04060187.K 1 6 6

	A	E	H	D
P04050177	50	15	12,5	8
P04060187	60	18	14	10
P04070127	68	22	14,5	12
P04090197	90	36	19	12

RECTANGULAR PADLOCK ADITUS for gates. **BODY: PAINTED SATIN BRASS MM 70.**

Shaft material: chrome-plated carbonitrided steel Ø 12. Shaft ball-locking.

SHAFT CLEARANCE MM 22X14,5

2 KEYS.

P04070127 1 6 6

RECTANGULAR PADLOCK ADITUS for gates. **BODY: PAINTED SATIN BRASS MM 70.**

Shaft material: chrome-plated carbonitrided steel Ø 12. Shaft ball-locking.

SHAFT CLEARANCE MM 22X14,5

2 KEYS. ISEO CODING.

P04070127.K 1 6 6

RECTANGULAR PADLOCK ADITUS for gates. **BODY: PAINTED SATIN BRASS MM 90.**

Shaft material: chrome-plated carbonitrided steel Ø 12. Shaft ball-locking.

SHAFT CLEARANCE MM 36X19.

2 KEYS.

P04090197 1 6 6

RECTANGULAR PADLOCK ADITUS for gates. **BODY: PAINTED SATIN BRASS MM 90.**

Shaft material: chrome-plated carbonitrided steel Ø 12. Shaft ball-locking.

SHAFT CLEARANCE MM 36X19.

2 KEYS. ISEO CODING.

P04090197.K 1 6 6

Code
Single
Multiple
package
Min. ord.

Aditus



RECTANGULAR **ARMoured** PADLOCK ADITUS for gates. **BRASS BODY MM 60.** Armour material: chrome-plated, carbonitrided and sandblasted. Shaft material: chrome-plated carbonitrided steel Ø 10, opening grip. Shaft ball-locking.

SHAFT CLEARANCE MM 22X11,5. 2 KEYS.

P04960227 1 6 6



RECTANGULAR **ARMoured** PADLOCK ADITUS for gates. **BRASS BODY MM 60.**

Armour material: chrome-plated, carbonitrided and sandblasted. Shaft material: chrome-plated carbonitrided steel Ø 10, Shaft ball-locking. **SHAFT CLEARANCE MM 22X11,5.**

2 KEYS. ISEO CODING.

P04960227.K 1 6 6

RECTANGULAR **ARMoured** PADLOCK ADITUS for gates. **BRASS BODY MM 70.**

Armour material: chrome-plated, carbonitrided and sandblasted. Shaft material: chrome-plated carbonitrided steel Ø 12, opening grip. Shaft ball-locking.

SHAFT CLEARANCE MM 22X15. 2 KEYS.

P04970227 1 6 6

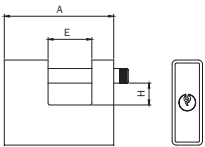

RECTANGULAR **ARMoured** PADLOCK ADITUS for gates. **BRASS BODY MM 70.**

Armour material: chrome-plated, carbonitrided and sandblasted. Shaft material: chrome-plated carbonitrided steel Ø 12, opening grip. Shaft ball-locking. **SHAFT CLEARANCE MM 22X15.**

2 KEYS. ISEO CODING.

P04970227.K 1 6 6

	A	E	H	D
P04960227	62	22	11,5	10
P04970227	71	22	15	12
P04990367	91	36	18	12

RECTANGULAR **ARMoured** PADLOCK ADITUS for gates. **BRASS BODY MM 90.**

Armour material: chrome-plated, carbonitrided and sandblasted. Shaft material: chrome-plated carbonitrided steel Ø 12, opening grip. Shaft ball-locking.

SHAFT CLEARANCE MM 36X18. 2 KEYS.

P04990367 1 6 6

RECTANGULAR **ARMoured** PADLOCK ADITUS for gates. **BRASS BODY MM 90.**

Armour material: chrome-plated, carbonitrided and sandblasted. Shaft material: chrome-plated carbonitrided steel Ø 12, opening grip. Shaft ball-locking. **SHAFT CLEARANCE MM 36X18.**

2 KEYS. ISEO CODING.

P04990367.K 1 6 6

Accessories

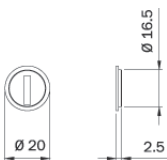

ANTI-DRILL DISK for padlock 809*

For keys with a max thickness of 3,7 mm

004377 50 - 50

FLOOR ANCHOR BRASS HOUSING for rectangular padlocks 804-805-809 series

004907 1 - 1

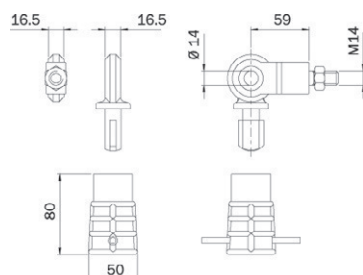
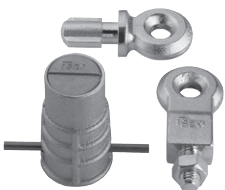

Components

**Iustus
Aditus**

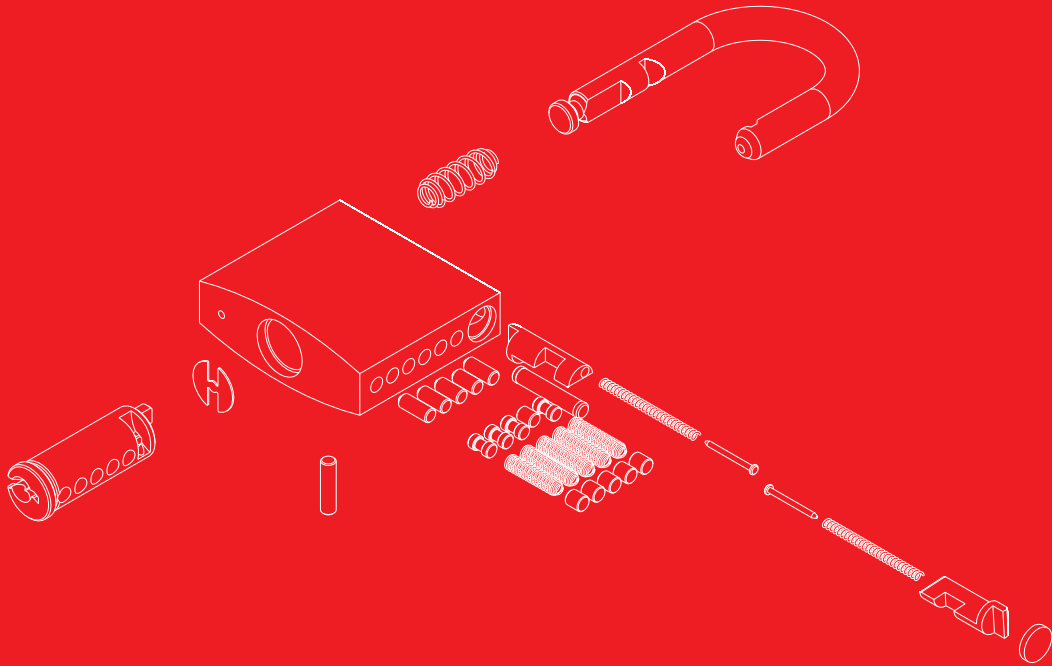

Code
Single
Multiple
package
Min. ord.

Padlocks

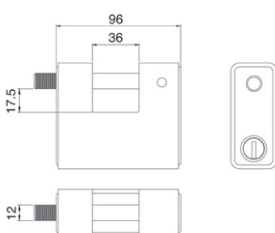

RECTANGULAR padlock BOXER, **FULLY ARMoured**, for gates.

Body in zamak and 96 mm case in chrome-plated carbonitrided steel.

TO BE USED WITH mm 40 (30+10) EUROPEAN SINGLE PROFILE CYLINDER,

with projecting cam. STAINLESS STEEL shaft Ø 12,

opening grip. Shaft ball-locking. **36 x 17,5 mm shaft clearance.**

When the padlock is open the case can be removed to place the cylinder.

Cylinder to be ordered separately.

The key can be removed only when the padlock is closed.

809909I 1 - 1

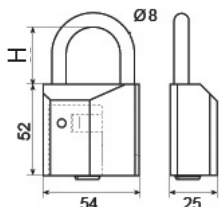

UNIVERSAL padlock. PREARRANGED FOR mm 40 (30+10) EUROPEAN

PROFILE CYLINDER, with projecting cam.

54 mm body in satin nickel-plated brass.

STEEL shaft Ø 8, 30 or 50 mm shaft clearance.

Cylinder to be ordered separately.

H= 30 mm carbonitrided steel shaft **40006000000030** 1 - 1

H= 50 mm **stainless steel shaft** **40006000000050** 1 - 1

H= 30 mm carbonitrided steel shaft
The key can be removed only when the padlock is closed. **4000600000SZ30** 1 - 1

H= 50 mm **stainless steel shaft**
The key can be removed only when the padlock is closed. **4000600000SZ50** 1 - 1

Code Single package Multiple package Min. ord.

Solid brass padlocks



IUSTUS shackle padlock. **BODY IN BRASS.** Chrome-plated steel shackle. (key blank 020259). Antipick disk.

50 mm, 5 pins, 28 mm shackle	800507W.SA	1	10	10
60 mm, 5 pins, 35 mm shackle	800607W.SA	1	10	10
70 mm, 5 pins, 44 mm shackle	800707W.SA	1	10	10



A	H	D
45	25	7
50	28	8
60	35	10
70	44	12



IUSTUS long shackle padlock. **BODY IN BRASS.** Chrome-plated steel shackle. (key blank 020259). Antipick disk.

50 mm, 5 pins, 50 mm shackle	802507W.SA	1	10	10
50 mm, 5 pins, 90 mm shackle	802527W.SA	1	10	10



A	H	D
50	50	8
50	90	8



IUSTUS RECTANGULAR padlock for gates. **mm 70 BODY IN BRASS.**

Shaft in chrome-plated carbonitrided steel Ø 12, opening grip.

Shaft ball-locking (key blank 020259).

mm 20 X 15 SHAFT CLEARANCE.	804707W.SA	1	6	6
------------------------------------	-------------------	---	---	---

IUSTUS RECTANGULAR padlock for gates. **mm 90 BODY IN BRASS.**

Shaft in chrome-plated carbonitrided steel Ø 12, opening grip.

Shaft ball-locking (key blank 020259).

mm 36 X 18 SHAFT CLEARANCE.	804907W.SA	1	6	6
------------------------------------	-------------------	---	---	---

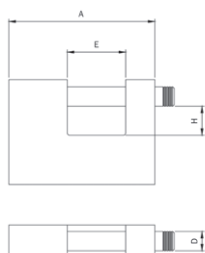

A	E	H	D
70	20	15	12
90	36	18	12

Code
Single
package
Multiple
package
Min. ord.

Specific components

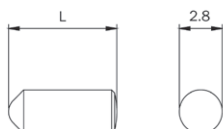

1000 pieces KIT. Brass pin for **F5** cylinders and **IUSTUS** padlocks coding. (for big keys).

mm 2,8x5,0 step 0	0032050	1000	-	1
mm 2,8x5,4 step 1	0032054	1000	-	1
mm 2,8x5,8 step 2	0032058	1000	-	1
mm 2,8x6,2 step 3	0032062	1000	-	1
mm 2,8x6,6 step 4	0032066	1000	-	1
mm 2,8x7,0 step 5	0032070	1000	-	1
mm 2,8x7,4 step 6	0032074	1000	-	1
mm 2,8x7,8 step 7	0032078	1000	-	1
mm 2,8x8,2 step 8	0032082	1000	-	1

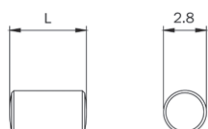

1000 pieces KIT. Anti-picking brass top pin for **F5** cylinders.
IUSTUS padlocks: mm **45 - 50 - 60 - 70** and mm **70 - 90** for gates.
mm 2,8x5

0033050	1000	-	1
----------------	------	---	---

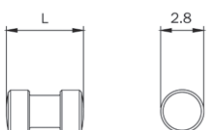

1000 pieces KIT. Brass top pin for **F5** cylinders,
IUSTUS padlocks: mm **45 - 50 - 60 - 70** and mm **70 - 90** for gates.
mm 2,8x5

0034050	1000	-	1
----------------	------	---	---

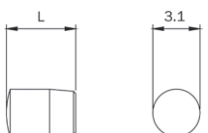

1000 pieces KIT. Brass cone shaped plug for **F5** cylinders,
IUSTUS padlocks: mm **45 - 50** and mm **70** for gates.
mm 3,1x4,5

0035049	1000	-	1
----------------	------	---	---

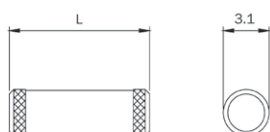

1000 pieces KIT. Plug.
For mm 60 shackle padlocks, mm **3,1x9,5**
For mm 70 shackle padlocks and mm 90 rectangular padlocks,
mm **3,1x14,5**

0035095	1000	-	1
0035145	1000	-	1

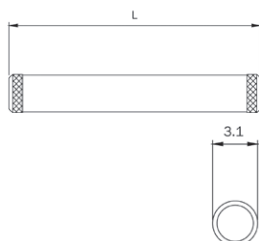

200 pieces KIT. Cylinders retaining pin
mm 45 - 50 shackle padlocks, mm **3,1x20,5**
mm 60 shackle padlocks, mm **3,1x25,5**
mm 70 shackle padlocks, mm **3,1x30,5**

0036205	200	-	1
0036255	200	-	1
0036305	200	-	1

mm 70 rectangular padlocks, mm 3,1x21,5	0036215	200	-	1
mm 90 rectangular padlocks, mm 3,1x31,5	0036315	200	-	1

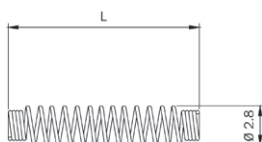

1000 pieces KIT. Spring for **F5** cylinders, **IUSTUS** padlocks
mm **45 - 50 - 60 - 7** and mm **70 - 90** for gates.
mm \varnothing 2,8x13

0038130	1000	-	1
----------------	------	---	---